



Andy Beshear
GOVERNOR

TRANSPORTATION CABINET

200 Mero Street
Frankfort, Kentucky 40601

Jim Gray
SECRETARY

February 21, 2024

CALL NO. 325
CONTRACT ID NO. 242978
ADDENDUM # 1

Subject: Anderson County, FE02 003 9002 B00007L&R 61.90
Letting February 22, 2024

- (1) Revised - Special Note - Pages 21-24 of 71
- (2) Revised - Proposal Bid Items - Pages 70-71 of 71
- (3) Revised - Plan Sheets - S01, R02, R07
- (4) Revised Plans Posted in Project Related Information

Proposal revisions are available at <http://transportation.ky.gov/Construction-Procurement/>.

If you have any questions, please contact us at 502-564-3500.

Sincerely,

Rachel Mills,

A handwritten signature in black ink that reads "Rachel Mills".

Rachel Mills, P.E.
Director
Division of Construction Procurement

RM:mr
Enclosures

SPECIAL NOTE FOR CONCRETE SEALING

These Notes or designated portions thereof, apply where so indicated on the plans, proposals or bidding instruction.

I. DESCRIPTION. Perform all work in accordance with the Department's current Standard Specifications, and applicable Supplemental Specifications, the attached sketches, and these Notes. Section references are to the Standard Specifications.

This work consists of:

1. Furnish all labor, materials, tools, equipment, and incidental items necessary to complete the work.
2. Provide safe access to the bridge, in accordance with Section 107.01.01, for the Engineer to sound possible repair areas and for workers to complete the construction.
3. Repair delaminated or spalled areas as applicable in accordance with the Special Note for Concrete Patching.
4. Apply Ordinary Surface Finish.
5. Prepare the surfaces to receive sealing.
6. Apply concrete sealing.
7. Any other work as specified as part of this contract.

II. MATERIALS.

A. Sealer. Use one of the following:

Product	Supplier
Protectosil BHN	Evonik Industries
Protectosil 300S	Evonik Industries
TK-590-40 Tri-Silane 40%	TK Products
SW-244-100	Chemical Products Industries, Inc.
TK-590-1 MS Tri-Silane	TK Products
MasterProtect H1000	BASF
Aquanil Plus 40	ChemMasters
SIL-ACT ATS-100	Advanced Chemical Technologies
Certivex Penseal BTS 100%	Vexcon
Pentreat 244-40	W.R. Meadows
Aquanil Plus 40A	ChemMasters

- B. Coverage Rate:** Follow all manufacturers recommendations for coverage rates except the application rate must not exceed the square footage coverage rate per gallon of sealer as given in the chart below. If the manufacturer recommends a coverage rate greater than given in the table below, apply sealer at the rate given in the table below for the chosen sealers silane percentage.

% Silane	Coverage rate (ft ² /gallon)
100	300
40	120
20	60

III. CONSTRUCTION.

- A. Perform Concrete Repairs.** Repair concrete surface in accordance with the Special Note for Concrete Patching.
- B. Curing Compound.** Contrary to Section 609.03.12 of the specifications, curing compound is not to be used on the deck due to potentially causing issues with the concrete sealer. During the deck pour, finishing, and tining operations the Class AA concrete shall be kept continuously moist with the use of a mister until burlap or curing blankets are applied to the surface. At no point should water be pooling or running off the surface or the surface of the concrete be allowed to become dry. After the burlap or curing blankets are installed, cure in accordance with the specifications. Include all costs in the unit price bid for Class AA concrete. Failure to properly cure the concrete in accordance with this note and the specifications may result in weakened or cracked concrete. If the concrete is weakened or cracked due to improper curing, the contractor will be responsible for providing alternates to fix the issues to the Engineer for review and the contractor will be solely responsible for all costs to do so, up to complete replacement. Do not begin any construction on fixing any issues without approval of the Engineer.
- C. Apply Ordinary Surface Finish.** In addition to new concrete, areas receiving epoxy injection, concrete patching, and other surface imperfections, including areas of minor cracking, should receive Ordinary Surface Finish in accordance with Section 601.03.18 of the Standard Specifications. Existing structural items not newly placed, patched, or repaired may be exempt from Ordinary Surface Finish. Use mortar of the same cement and fine aggregate as the concrete patching, or as directed by the Engineer. Payment will be incidental to Concrete Sealing. Finish surface of bridge decks in accordance with Section 609 of the Standard Specifications.
- D. Areas to Receive Concrete Sealing:**
1. Every exposed surface above the groundline of the Pier 2 and Pier 5 columns and struts.
 2. All exposed surfaces of the barrier walls, parapets, curbs, and plinths.
 3. If the contract documents include the Special Note for Concrete Coating, do not apply concrete sealer to the areas where Concrete Coating is specified.

- E. Cleaning the Concrete Surfaces to be sealed.** Dry clean the concrete to remove all loose debris. Remove all visible hydrocarbons from the surface with detergent approved by the manufacturer of the deck sealant. Pressure wash all surfaces to be sealed at 2000 to 3000 psi. Install pressure gauges at each wand to verify pressure. Use 30° fan tip or as recommended by the manufacturer of the sealant. Hold pressure washing wand a minimum of 45° from the surfaces with a maximum stand-off distance of 12 inches.
- F. Sealing the Concrete.** Allow new concrete to cure a minimum 28 days prior to application of sealer. Monitor weather conditions prior to sealer application. Refer to manufacturer's recommendations for proper ambient conditions. Do not apply sealer if precipitation is anticipated within the time stated by the manufacturer. Allow the concrete to dry 24 hours (after washing or rain event) before sealer application. The bridge deck can be reopened to traffic while drying. Sealer must be applied within 48 hours of washing or the concrete must be rewashed. Divide the concrete into predefined areas of specific square footage to aid in determining usage. Comply with manufacturer's usage recommendation. Using a low-pressure pump, apply sealer and spread evenly with broom or squeegee; do not allow pooling to remain. When each predefined area is complete, measure the amount of sealer used to verify proper usage. After sealing, follow manufacturer's recommended cure time before opening to traffic. On vertical surfaces, apply the sealer in a flooding application from the bottom up, so the material runs down 6 to 8 inches below the spray pattern.
- G. Inspection:** Monitor all aspects of the project to assure compliance to this specification. Observe and document general conditions during the entirety of the project. Verify that each phase of work has been satisfactorily completed prior to beginning the next phase. Phases are described as follows:
1. Dry cleaning to remove loose debris, verify and document:
 - a. All debris has been removed and disposed of properly.
 2. Removal of hydrocarbons, verify and document:
 - a. The manufacturer's recommended detergent is used for removal.
 - b. Hydrocarbons have been satisfactorily removed.
 3. Pressure washing, verify and document:
 - a. Washing pressure at the wand.
 - b. Tip size used.
 - c. Wash angle and stand-off distance.
 - d. The concrete is satisfactorily cleaned.
 4. Sealer application, verify and document:
 - a. Proper cure time for new concrete.
 - b. Concrete surface is dry.
 - c. Document time since washed.
 - d. Was the bridge deck opened to traffic after washing?
 - e. Document ambient temperature, surface temperature, relative humidity, and dew point.

- f. Application and distribution method.
- g. Coverage to be complete and even.
- h. Material is not allowed to remain pooled.
- i. Monitor material usage.
- j. No traffic on the bridge decks until proper cure time is allowed.

IV. MEASUREMENT

- A. Concrete Sealing.** The Department will measure the quantity per square feet of each area sealed.

V. PAYMENT

- A. Concrete Sealing.** Payment at the contract unit price per square feet is full compensation for the following: (1) Furnish all labor, materials, tools, and equipment; (2) Cleaning; (3) Sealing; (4) Maintain & control traffic; and, (5) Any other work specified as part of this contract.

PROPOSAL BID ITEMS

Report Date 2/21/24

Section: 0001 - ROADWAY

LINE	BID CODE	ALT	DESCRIPTION	QUANTITY	UNIT	UNIT PRIC	FP	AMOUNT
0010	00003		CRUSHED STONE BASE	356.00	TON		\$	
0020	00217		CL4 ASPH BASE 1.00D PG64-22	424.00	TON		\$	
0030	00219		CL4 ASPH BASE 1.00D PG76-22	170.00	TON		\$	
0040	00342		CL4 ASPH SURF 0.38A PG76-22	86.00	TON		\$	
0050	00522		STORM SEWER PIPE-18 IN	2,358.00	LF		\$	
0060	01440		SLOPED BOX INLET-OUTLET TYPE 1	4.00	EACH		\$	
0070	01982		DELINEATOR FOR GUARDRAIL MONO DIRECTIONAL WHITE	3.00	EACH		\$	
0080	01983		DELINEATOR FOR GUARDRAIL MONO DIRECTIONAL YELLOW	6.00	EACH		\$	
0090	02014		BARRICADE-TYPE III	8.00	EACH		\$	
0100	02165		REMOVE PAVED DITCH	257.00	SQYD		\$	
0110	02351		GUARDRAIL-STEEL W BEAM-S FACE	450.00	LF		\$	
0120	02352		GUARDRAIL-STEEL W BEAM-D FACE	275.00	LF		\$	
0130	02360		GUARDRAIL TERMINAL SECTION NO 1	2.00	EACH		\$	
0140	02365		CRASH CUSHION TYPE IX-A	2.00	EACH		\$	
0150	02367		GUARDRAIL END TREATMENT TYPE 1	3.00	EACH		\$	
0160	02381		REMOVE GUARDRAIL	1,050.00	LF		\$	
0170	02397		TEMP GUARDRAIL	750.00	LF		\$	
0180	02483		CHANNEL LINING CLASS II	50.00	TON		\$	
0190	02562		TEMPORARY SIGNS	500.00	SQFT		\$	
0200	02650		MAINTAIN & CONTROL TRAFFIC B000007	1.00	LS		\$	
0210	02655		CROSSOVER CROSSOVER NO. 1 & NO. 2	1.00	LS		\$	
0220	02655		CROSSOVER CROSSOVER NO. 3 & NO. 4	1.00	LS		\$	
0230	02671		PORTABLE CHANGEABLE MESSAGE SIGN	2.00	EACH		\$	
0240	02696		SHOULDER RUMBLE STRIPS	4,620.00	LF		\$	
0250	02775		ARROW PANEL	2.00	EACH		\$	
0260	03171		CONCRETE BARRIER WALL TYPE 9T	1,200.00	LF		\$	
0270	03225		TUBULAR MARKERS	276.00	EACH		\$	
0280	06511		PAVE STRIPING-TEMP PAINT-6 IN	45,000.00	LF		\$	
0290	06542		PAVE STRIPING-THERMO-6 IN W	15,000.00	LF		\$	
0300	06543		PAVE STRIPING-THERMO-6 IN Y	12,000.00	LF		\$	
0310	06549		PAVE STRIPING-TEMP REM TAPE-B	500.00	LF		\$	
0320	06613		INLAID PAVEMENT MARKER-B W/R	150.00	EACH		\$	
0330	08903		CRASH CUSHION TY VI CLASS BT TL3 (REVISED 2-21-2024)	2.00	EACH		\$	
0340	20318ES508		RELOCATE CONC BARRIER WALL	1,200.00	LF		\$	
0350	20432ES112		REMOVE CRASH CUSHION	2.00	EACH		\$	
0360	21415ND		EROSION CONTROL	1.00	LS		\$	
0370	23139EN		STRIPING REMOVAL	45,000.00	LF		\$	
0380	23952EC		DRAINAGE JUNCTION BOX TY B	6.00	EACH		\$	
0390	25078ED		THRIE BEAM GUARDRAIL TRANSITION TL-3 (REVISED 2-21-24)	8.00	EACH		\$	

Section: 0002 BRIDGE OVER KY RIVER B000007 L & R

PROPOSAL BID ITEMS

Report Date 2/21/24

SECTION: 0002 - BRIDGE - OVER RT RIVER B00007 L&R

LINE	BID CODE	ALT	DESCRIPTION	QUANTITY	UNIT	UNIT PRIC	FP	AMOUNT
0400	02545		CLEARING AND GRUBBING -	1.00	LS		\$	
0410	03295		EXPAN JOINT REPLACE 2 IN	60.00	LF		\$	
0420	03299		ARMORED EDGE FOR CONCRETE	60.00	LF		\$	
0430	08151		STEEL REINFORCEMENT-EPOXY COATED	268.00	LB		\$	
0440	22146EN		CONCRETE PATCHING REPAIR	5,099.00	SQFT		\$	
0450	23032EN		BRIDGE BARRIER RETROFIT	4,596.00	LF		\$	
0460	23070NN		GIRDER REPAIR	4.00	EACH		\$	
0470	23378EC		CONCRETE SEALING (REVISED 2-21-24)	78,660.00	SQFT		\$	
0480	23494EC		INSPECTION WALKWAY	2,162.00	LF		\$	
0490	23859EC		FINGER EXPANSION JOINT	132.00	LF		\$	
0500	23949EC		BRIDGE CLEANING & PREVENTIVE MAINTENANCE	1.00	LS		\$	
0510	24084EC		STRINGER REPAIR	5.00	EACH		\$	
0520	24422EC		FLOOR BEAM RETROFIT	20.00	EACH		\$	
0530	24692EC		DECK DRAIN RETROFIT	84.00	EACH		\$	
0540	24879EC		STEEL REPAIR FLOORBEAM GRINDING	62.00	EACH		\$	
0550	24879EC		STEEL REPAIR TACK WELD REMOVAL	44.00	EACH		\$	
0560	24879EC		STEEL REPAIR TRIAXIAL CONSTRAINT	224.00	EACH		\$	
0570	24982EC		CONCRETE COATING -	1.00	LS		\$	
0580	25075EC		QUEUE PROTECTION VEHICLE	720.00	HOURL		\$	
0590	25117EC		FURNISH QUEUE PROTECTION VEHICLES	18.00	MONTH		\$	
0600	26136EC		PORTABLE QUEUE WARNING ALERT SYSTEM	18.00	MONTH		\$	
0610	26137EC		QUEUE WARNING PCMS	108.00	MONTH		\$	
0620	26138EC		QUEUE WARNING PORTABLE RADAR SENSORS	108.00	MONTH		\$	
0630	26141EC		GALVANIC ANODE	2,940.00	EACH		\$	

Section: 0003 - MOBILIZATION AND DEMOBILIZATION

LINE	BID CODE	ALT	DESCRIPTION	QUANTITY	UNIT	UNIT PRIC	FP	AMOUNT
0640	02568		MOBILIZATION	1.00	LS		\$	
0650	02569		DEMOBILIZATION	1.00	LS		\$	

TRANSPORTATION CABINET DEPARTMENT OF HIGHWAYS

ANDERSON COUNTY BLUEGRASS PARKWAY (BG-9002) OVER KENTUCKY RIVER

INDEX OF SHEETS

Sheet No.	Title Sheet	Description
S01	General Notes	
S02	Layout	
S03	Framing Plan	
S04	Typical Section	
S05	Bridge Railing Over Wingwalls	
S06	Floorbeam Grinding	
S07	Floorbeam Retrofit	
S08	Stringer Repair	
S09	Girder Repair	
S10	Triaxial Constraint Retrofit	
S11	Abutment 6 Joint Replacement	
S12	Finger Joint Replacement	
S13-S17	WB Pier 2 Patching	
S18	WB Pier 5 Patching	
S19	EB Pier 2 Patching	
S20	EB Pier 5 Patching	
S21	Deck Patching	
S22-S26	Deck Drain Retrofit	
S27	Inspection Walk Replacement	
S28-S29	Inspection Walk Gate	
S30	Crossover Typical Section	
R01	General Summaries & General Notes	
R02	Crossover No. 1	
R03	Crossover No. 2	
R04	Crossover No. 3	
R05	Crossover No. 4	
R06	Guardrail	
R07	Crossover No. 1 & 2 Profile	
R08	Crossover No. 3 & 4 Profile	
R09	Crossover No. 3 & 4 Profile	

ESTIMATE OF QUANTITIES

* REPAIR NUMBER BID ITEM CODE	17	02568	02569	4.8	03295	8	03299	8	08151	122146EN	23032EN	23070NN	23378EC	23494EC	23859EC	23949EC	24084EC	24422EC	24692EC	24879EC	24879EC	24879EC	24982EC	25075EC	25117EC	26136EC	26137EC	26138EC	26141EC	10	
BID ITEM	Clearing And Grubbing	Mobilization	Demobilization	Expansion Joint Replace 2 IN	Armored Edge For Concrete	Steel Reinforcement - Epoxy Coated	Concrete Patching Repair	Bridge Barrier Retrofit	Girder Repair	Concrete Sealing	Inspection Walkway	Finger Expansion Joint	Bridge Cleaning & Preventive Maintenance	Stringer Repair	Floorbeam Retrofit	Deck Drain Retrofit	Steel Repair Grinding	Steel Repair Triaxial Constraint	Steel Repair Removal	Concrete Coating	Queue Protection Vehicle	Furnish Queue Protection Vehicles	Portable Queue Warning Alert System	Queue Warning PCMS	Queue Warning Portable Radar Sensors	Galvanic Anode	See Sheet R02 For Roadway Bid Items				
UNIT	L.S.	L.S.	L.S.	L.F.	L.F.	LBS.	S.F.	L.F.	Each	S.F.	L.F.	L.F.	L.S.	Each	Each	Each	Each	Each	Each	Hour	Month	Month	Month	Month	Month	Each	Each	Each	Each	Each	
WB Pier 2						272				8460																272					
WB Pier 5						1695				8650																1060					
EB Pier 2						1757				8020																944					
EB Pier 5						1284				8830																664					
WB Superstructure																															
EB Superstructure																															
BRIDGE TOTALS	1	1	1	60	60	268	5099	4596	4	78660	2162	132	1	5	20	84	62	224	44	1	720	18	18	108	108					2940	

* See Sheet S03 for Repair Identification Numbers

STRUCTURE SHEETS S01-S30	ROADWAY SHEETS R01-R09

	PREPARED BY AECOM	DATE: 1/12/2024 DESIGNED BY: J. JONES DETAILED BY: J. JONES	CHECKED BY Y. ZHAO Y. ZHAO	COUNTY OF ANDERSON DRAWING NUMBER 28839
	REVISION	DATE	TITLE SHEET CROSSING KENTUCKY RIVER	ROUTE BG 9002 SHEET NO. S01

SPECIFICATIONS

2019 Standard Specifications for Road and Bridge Construction.

2020 AASHTO LRFD Bridge Design Specifications

SPECIAL PROVISIONS

Special Note For Clearing Bridge Site

Special Note For Completion and Liquidated Damages

Special Note For Concrete Coating

Special Note For Concrete Patching Repair

Special Note For Concrete Sealing

Special Note For Embedded Galvanic Anodes

Special Note For Inspection Walkway Replacement

Special Note For Maintenance of Traffic

Special Note For Painting Structural Steel Repairs

Special Note For Portable Queue Warning Alert System

Special Note For Queue Protection Vehicle

Special Note For Non-Tracking Tack Coat

Special Note For Portable Changeable Message Sign

Special Note For Waterblasting Stripping Removal

See Proposal For Other Pertinent and Applicable Special Notes

STANDARD DRAWINGS

BHS-010 Railing System 40 Inch Single Slope

BHS-014 Thrie-Beam Guardrail Transition (TL-3)

BIE-001-14 Armored Edges

BIE-003 Expansion Joint Replacement 1"-3"

BIE-005 Expansion Joint Replacement General Notes

See Sheet R01 For Roadway Standard Drawings

GENERAL NOTES

BEFORE YOU DIG

THE CONTRACTOR IS INSTRUCTED TO CALL 1-800-752-6007 TO REACH KY 811, THE ONE-CALL SYSTEM FOR INFORMATION ON THE LOCATION OF EXISTING UNDERGROUND UTILITIES. THE CALL IS TO BE PLACED A MINIMUM OF TWO (2) AND NO MORE THAN TEN (10) BUSINESS DAYS PRIOR TO EXCAVATION. THE CONTRACTOR SHOULD BE AWARE THAT OWNERS OF UNDERGROUND FACILITIES ARE NOT REQUIRED TO BE MEMBERS OF THE KY 811 ONE-CALL BEFORE-U-DIG (BUD) SERVICE. THE CONTRACTOR MUST COORDINATE EXCAVATION WITH THE UTILITY OWNERS, INCLUDING THOSE WHO DO NOT SUBSCRIBE TO KY 811. IT MAY BE NECESSARY FOR THE CONTRACTOR TO CONTACT THE COUNTY COURT CLERK TO DETERMINE WHAT UTILITY COMPANIES HAVE FACILITIES IN THE AREA.

STANDARD DRAWINGS

STANDARD DRAWINGS ARE NOT ATTACHED TO THESE PLANS. A STANDARD DRAWING BOOK AND THE HEADWALL SUPPLEMENTAL BOOK MAY BE OBTAINED FROM THE POLICY SUPPORT BRANCH OF THE DEPARTMENT OF ADMINISTRATIVE SERVICES IN FRANKFORT, KY AT (502) 564-3670.

NOTICE - CAUTION CLASSIFICATION

SEE THE CURRENT EDITION OF THE KENTUCKY STANDARD SPECIFICATIONS FOR ROAD AND BRIDGE CONSTRUCTION: THE RIGHT IS RESERVED BY THE DEPARTMENT TO HAVE OTHER WORK PERFORMED BY OTHER CONTRACTORS AND BY ITS OWN FORCES AND TO PERMIT PUBLIC UTILITY COMPANIES AND OTHERS TO DO WORK DURING THE CONSTRUCTION OF, AND WITHIN THE LIMITS OF OR ADJACENT TO, THE PROJECT. THE CONTRACTOR SHALL CONDUCT THEIR OPERATIONS AND COOPERATE WITH SUCH OTHER PARTIES SO THAT INTERFERENCE WITH SUCH OTHER WORK WILL BE REDUCED TO A MINIMUM. THE CONTRACTOR SHALL AGREE, AND HEREBY DOES AGREE, TO MAKE NO CLAIMS AGAINST THE DEPARTMENT FOR ADDITIONAL COMPENSATION DUE TO DELAYS OR OTHER CONDITIONS CREATED BY THE OPERATIONS OF SUCH OTHER PARTIES. SHOULD A DIFFERENCE OF OPINION ARISE AS TO THE RIGHTS OF THE CONTRACTOR AND OTHERS WORKING WITHIN THE LIMITS OF OR ADJACENT TO THE PROJECT, THE ENGINEER WILL DECIDE AS TO THE RESPECTIVE RIGHTS OF THE VARIOUS PARTIES INVOLVED IN ORDER TO ASSURE THE COMPLETION OF THE DEPARTMENT'S WORK IN GENERAL HARMONY AND IN A SATISFACTORY MANNER, AND THEIR DECISION SHALL BE FINAL AND BINDING UPON THE CONTRACTOR.

FAILURE TO COMPLETE WORK ON TIME

FOR EACH CALENDAR DAY BEYOND THE AGREED UPON FIXED COMPLETION DATE OR SPECIFIED WORKING DAYS, THE DEPARTMENT WILL ASSESS LIQUIDATED DAMAGES PER THE CURRENT EDITION OF THE STANDARD SPECIFICATIONS FOR ROAD AND BRIDGE CONSTRUCTION.

COMPACTION OF ASPHALT MIXTURES

WILL ACCEPT THE COMPACTION OF ASPHALT MIXTURES FURNISHED FOR DRIVING LANES AT ONE INCH (25 MM) OR GREATER ON THIS PROJECT BY OPTION A ACCORDING TO THE CURRENT STANDARD SPECIFICATIONS. USE JOINT CORES AS DESCRIBED IN THE STANDARD SPECIFICATIONS FOR SURFACE MIXTURES ONLY. WILL ACCEPT THE COMPACTION OF ALL OTHER ASPHALT MIXTURES BY OPTION B.

EROSION AND SEDIMENT CONTROL

PRIOR TO ANY CLEARING, GRUBBING AND EXCAVATION, CONSTRUCT PERIMETER CONTROLS SUCH AS BUT NOT LIMITED TO TEMPORARY SILT FENCE, PERMANENT EROSION AND SEDIMENT CONTROLS MEASURES, SILT TRAPS, SEDIMENTATION BASINS, ETC. TO ENSURE THAT DISTURBED SEDIMENT DOES NOT LEAVE THE PROJECT SITE AND/OR TO CONTROL SEDIMENT PER THE PLANS.

MARKING REMOVAL

REMOVAL OF THE EXISTING STRIPING WILL BE DONE BY WATER ABRASIVE BLASTING SO THE STRIPE IS NO LONGER VISIBLE ON THE PAVEMENT WITHOUT DAMAGING THE PAVEMENT. ANY DAMAGE TO THE PAVEMENT IS THE RESPONSIBILITY OF THE CONTRACTOR.

CONSTRUCTION MATERIAL DISPOSAL

ALL CONCRETE PAVEMENT, ASPHALT MATERIAL, AND ANY OTHER MATERIAL THAT IS REQUIRED TO BE REMOVED SHALL BE DISPOSED OFF OF THE RIGHT-OF-WAY AT SITES ACQUIRED BY THE CONTRACTOR AND APPROVED BY THE ENGINEER, AT NO ADDITIONAL COST TO THE DEPARTMENT, PER THE CURRENT EDITION OF THE KYTC STANDARD SPECIFICATIONS.

SIGNING

THE CONTRACTOR WILL COORDINATE WITH THE ENGINEER ON WHAT SIGNS WILL BE REMOVED AND/OR RESET/REPLACED PRIOR TO ANY WORK TAKING PLACE. THIS WORK WILL BE INCIDENTAL TO MAINTAIN AND CONTROL TRAFFIC.

BLASTING

BLASTING WILL NOT BE PERMITTED ON THIS PROJECT.

PIPE REMOVAL

REMOVAL OF ANY UNNECESSARY PIPE WILL BE INCIDENTAL TO THE PROJECT.

CROSSOVERS

CROSSOVERS ARE TO BE LEFT IN PLACE AFTER CONSTRUCTION. PERMANENT TUBULAR MARKERS SHALL BE PLACED EVERY 40' LONGITUDINAL ALONG THE CENTER OF THE CROSSOVER TO CLOSE THE CROSSOVERS AT COMPLETION.

GENERAL SUMMARY

ITEM	DESCRIPTION	UNITS	QUANTITY	ROADWAY TOTAL
3	CRUSHED STONE BASE	TON	3188	3188
217	CL4 ASPH BASE 1.00D PG64-22	TON	3812	3812
219	CL4 ASPH BASE 1.00D PG76-22	TON	1525	1525
342	CL4 ASPH SURF 0.38A PG76-22	TON	762	762
522	STORM SEWER PIPE-18 IN	LF	2358	2358
1440	SLOPED BOX INLET-OUTLET TYPE 1	EACH	4	4
2014	BARRICADE-TYPE III	EACH	8	8
2165	REMOVE PAVED DITCH	SQYD	257	257
2483	CHANNEL LINING CLASS II	TON	50	50
2562	TEMPORARY SIGNS	SQFT	500	500
2650	MAINTAIN AND CONTROL TRAFFIC	LS	1	1
2655	CROSSOVER (CROSSOVER NO. 1 & NO. 2)	LS	1	1
2655	CROSSOVER (CROSSOVER NO. 3 & NO. 4)	LS	1	1
2671	PORTABLE CHANGEABLE MESSAGE SIGN	EACH	2	2
2696	SHOULDER RUMBLE STRIPS	LF	4620	4620
2775	ARROW PANEL	EACH	2	2
3171	CONCRETE BARRIER WALL TYPE 9T	LF	1200	1200
3225	TUBULAR MARKERS	EACH	276	276
6511	PAVE STRIPING-TEMP PAINT-6 IN	LF	45000	45000
6542	PAVE STRIPING-THERMO-6 IN W	LF	15000	15000
6543	PAVE STRIPING-THERMO-6 IN Y	LF	12000	12000
6549	PAVE STRIPING-TEMP REM TAPE-B	LF	500	500
6613	INLAID PAVEMENT MARKER-B W/R	EACH	150	150
8903	CRASH CUSHION TY VI CLASS BT TL3	EACH	2	2
20318ES508	RELOCATE CONC BARRIER WALL	LF	1200	1200
21415ND	EROSION CONTROL	LS	1	1
23139EN	STRIPING REMOVAL	LF	45000	45000
23952EC	DRAINAGE JUNCTION BOX TY B	EACH	6	6

GUARDRAIL SUMMARY

LOCATION	ITEM DESCRIPTION		1982	1983	2360	2365	2367	2381	2397	
	ITEM CODE	UNIT TO BID								
TEMP GUARDRAIL	EB BLUEGRASS PARKWAY	LINEAR FEET	1982	1983	2360	2365	2367	2381	2397	
	TO 270+40	LT		3	1	1	1	1	1	
	TO 270+40	RT								
	TO 282+44	RT		1						
	TO 283+75	LT								
	WB BLUEGRASS PARKWAY									
	TO 270+40	LT								
	TO 270+40	RT								
	TO 282+44	LT		1						
	TO 283+98	RT								
	TOTAL:			3	6	2	2	3	2	8

ITEM DESCRIPTION	QUANTITY	ROADWAY TOTAL
DELINATOR FOR GUARDRAIL M/W	1	1
DELINATOR FOR GUARDRAIL M/Y	3	3
GUARDRAIL TERMINAL SECTION NO 1	1	1
CRASH CUSHION TYPE IX-A	1	1
GUARDRAIL END TREATMENT TYPE 1	1	1
REMOVE CRASH CUSHION	1	1
THREE BEAM GUARDRAIL TRANSITION TL-3	1	1
GUARDRAIL-STEEL W BEAM-S FACE	75	75
GUARDRAIL-STEEL W BEAM-D-FACE	100	100
REMOVE GUARDRAIL	100	100
TEMP GUARDRAIL	250	250



COMMONWEALTH OF KENTUCKY
DEPARTMENT OF HIGHWAYS

DRAWING TITLE: GENERAL SUMMARIES & GENERAL NOTES

DRAWING NO.
28839
SHEET NO.
R02

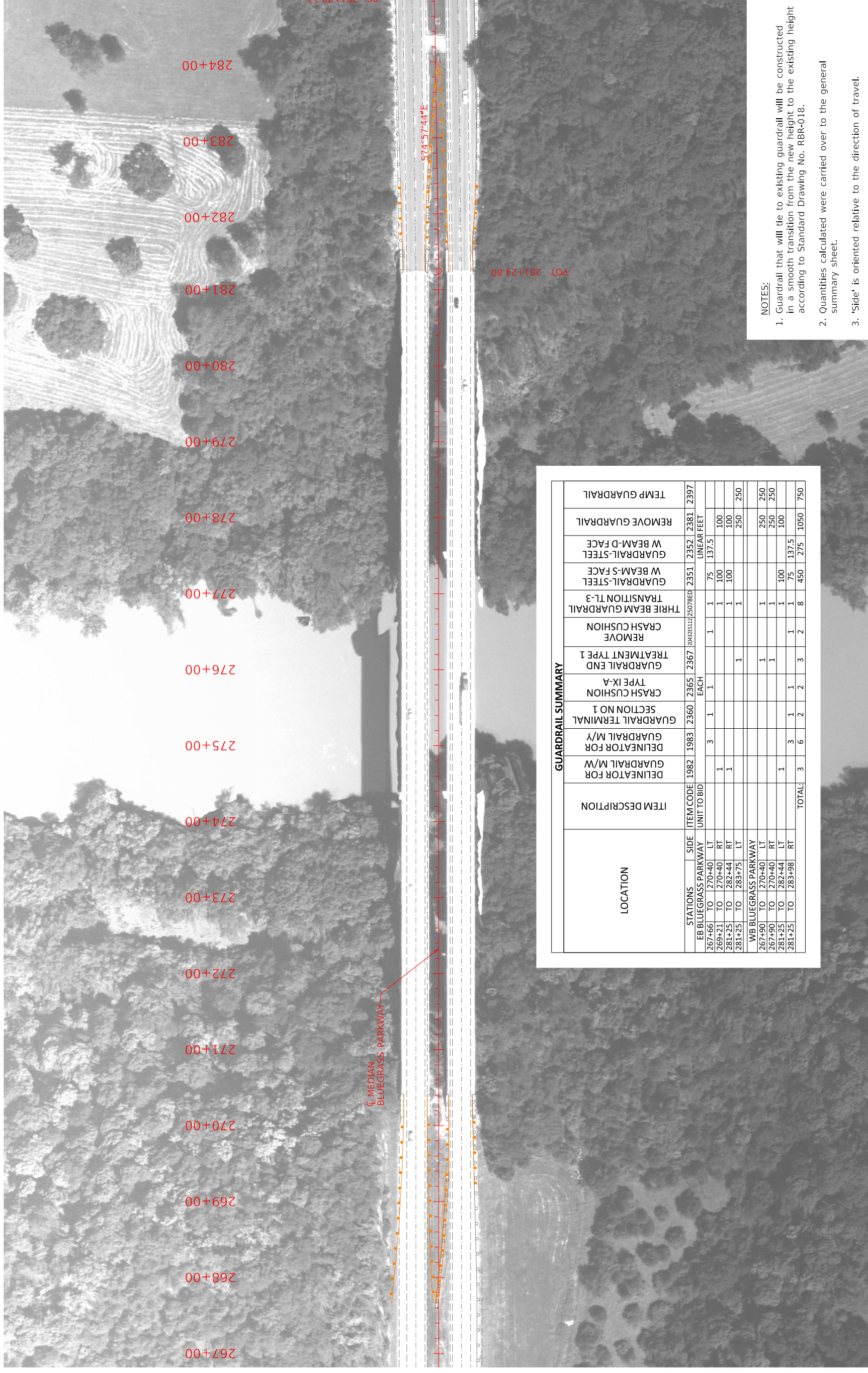

NOTES:
 1. Guardrail that will tie to existing guardrail will be constructed in a smooth transition from the new height to the existing height according to Standard Drawing No. RBR-018.
 2. Quantities calculated were carried over to the general summary sheet.
 3. 'Side' is oriented relative to the direction of travel.

LOCATION		ITEM DESCRIPTION	STATIONS	SIDE	ITEM CODE	UNIT TO BID	GUARDRAIL SUMMARY										
TO	FROM						DELINEATOR FOR GUARDRAIL M/W	DELINEATOR M/Y	GUARDRAIL TERMINAL SECTION NO 1	CRASH CUSHION TYPE IX-A	TREATMENT END TYPE 1	REMOVE CRASH CUSHION	THREE BEAM GUARDRAIL TRANSITION TL-3	W BEAM-S FACE GUARDRAIL-STEEL	W BEAM-D FACE GUARDRAIL-STEEL	REMOVE GUARDRAIL	TEMP GUARDRAIL
267+90	281+25		1882	RT		3											
267+90	270+40		1983	RT		3											
269+21	270+40		2360	RT		1											
281+25	282+44		2365	RT		1											
281+25	283+75		2367	LT		1											
267+90	270+40		2381	LT		1											
267+90	270+40		2381	RT		1											
281+25	282+44		2351	LT		1											
281+25	282+44		2351	RT		1											
281+25	283+75		2352	LT		1											
281+25	283+75		2352	RT		1											
TOTAL:							3	6	2	2	3	2	8	450	275	1050	750



COMMONWEALTH OF KENTUCKY
 DEPARTMENT OF HIGHWAYS

DRAWING TITLE: GUARDRAIL

HORIZONTAL SCALE: 1"=60'



STA 267+00 TO 284+00

DRAWING NO.
28839
SHEET NO.
R07

COUNTIES OF
ANDERSON & WOODFORD